

SUGGESTED PANEL CUTOUT

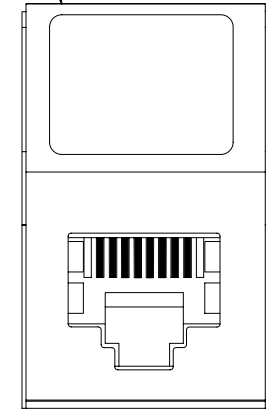
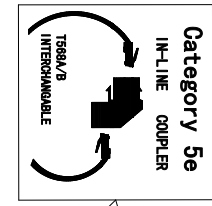
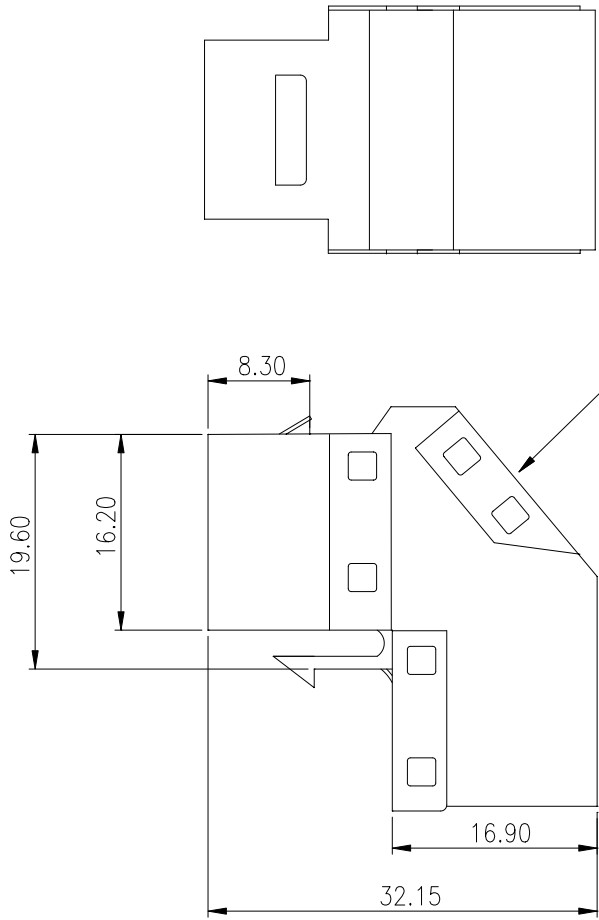
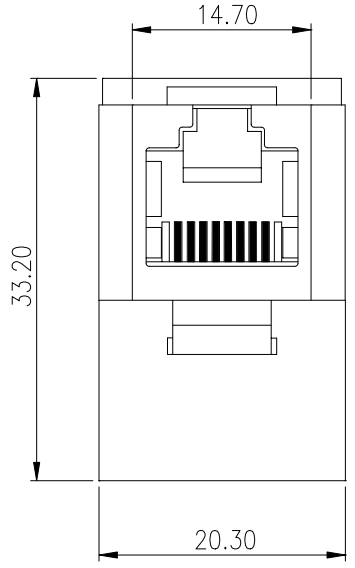

**MATERIAL**  
 Housing:ABS,UL94V-0  
 Spring Wire:Phospher Bronze with 50u  
 "Gold over 100u"Nickel undercoat  
 Temperature:-40C~68C  
 Humidity:10%~90%RH  
 Modular jack:750 mating cycles

**ELECTRICAL:**  
 Current rating:1.5Amps  
 Insulation resistance:500M0hm  
 Contact resistance:20M0hm  
 DC resistanc:0.10hm  
 Dielectric withstanding voltage:1000v

NET MECHANISM Corp				
www.cabling-ol.net				
SCALE	NONE		REV	A
UNIT	MM			
SHEET	1/1	DWG NO.		
DATE	11/13/04			
TITLE		2100-8S-C5e		
PART NO.		AC5-PS		