

210HD06G2XX PIN ASSIGNMENT		
A TYPE (P1)		A TYPE (P2)
1		1
2		2
3		3
4		4
5		5
6		6
7		7
8		8
9		9
10		10
11		11
12		12
13		13
14		14
15		15
16		16
17		17
18		18
19		19
SHELL		SHELL

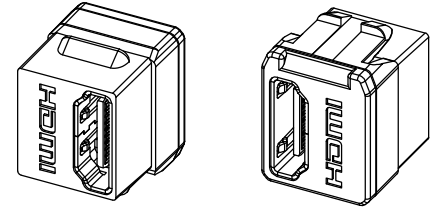

A TYPE (P1)

A TYPE (P2)

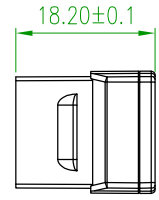
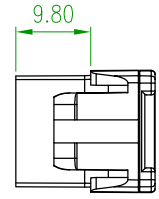
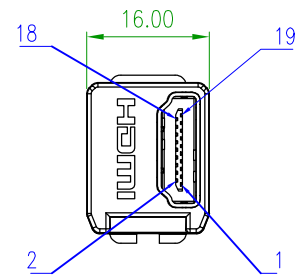
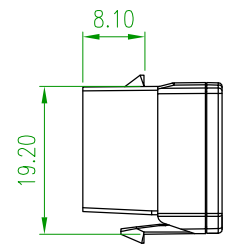
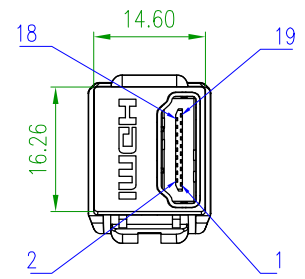

**MATERIAL**  
 Housing: High-impact Acrylonitrile Butadiene Styrene (ABS resin), UL 94 V-0 rated  
 PCB: FR4, t=1.0mm , UL 94 V-0 rated

**HDMI Connector:**  
 Shell: Copper alloy, plated with Tin-Lead  
 Plastic: High-impact Polybutylene terephthalate (PBT), UL 94 V-0 rated, Glass Filled 130°C  
 Contact: Copper Alloy  
 RoHS 2 compliant

**ELECTRICAL**  
 Voltage Rating: 40V AC (rms)  
 Contact Current Rating: 0.5 Amps Min.  
 Insulation Resistance: 100 M ohm Min  
 Dielectric Withstanding Voltage: 300 V AC  
 Contact Resistance: 30 m ohm Max.  
 Operation Temperature:-20°C to +85°C



DRAWN BY  
 Kihai Lee  
 APPROVED BY  
 Kevin Wu  
 UNIT: mm [inch]  
 TOLERANCES:

PART NO.	VER.
210HD06G2XX	2
CUSTOMER P/N.	

REV.	DESCRIPTION	DATE	3rd Angle Projection	
2	Add pin assignment	2019.05.22		-20 ±0.2   -50 ±0.4   -150 ±0.5   150- ±1.5   ANGLE ±2°
1	First edition	2013.06.10		

DATE: 2019.05.22   SCALE: 1:1   SHEET: 1/1