

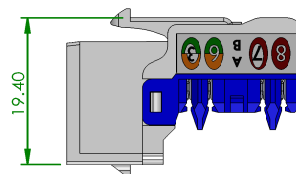

Intertek

ETL Verified to ANSI/TIA-568-C.2
Category 6A Connecting Hardware

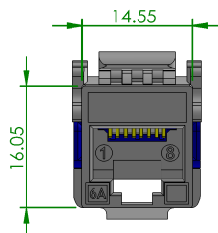
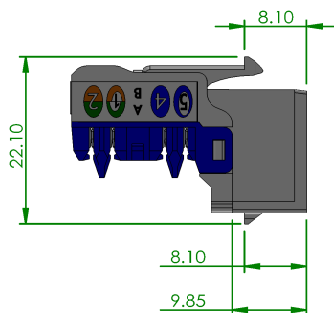
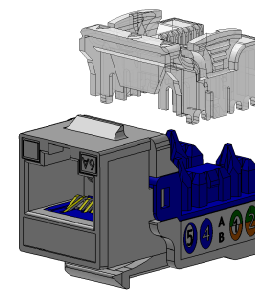
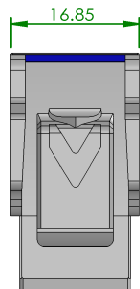

Wire Cap

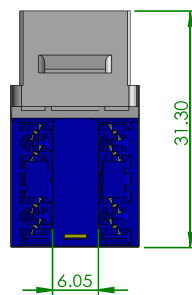
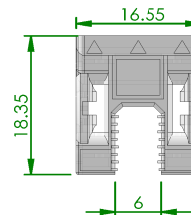

Material

- Housing: ABS UL94V-0 flame retardancy
- Spring Wire: Phosphor bronze 0.35t, plated with 50u" gold at contact area over 60u" nickel undercoat
- PCB: FR4
- IDC Terminals: Phosphor bronze 0.5t, plated with 100u" nickel
- IDC Block: High-impact Polycarbonate UL94V-2 flame retardancy

Solid Wire Range

- Conductor Diameters: 24AWG - 22AWG
- Insulation Diameters: 0.8mm - 1.1mm
- Cable Diameters: 5mm - 9mm

RoHS

DRAWN BY Nick Liu		Description KVA TIA-C6A Keystone Jack	
APPROVED BY Kevin Wu			
DIMENSIONS ARE MM [IN]		DWG. NO. 3013AKVA6AWH	REV.
TOLERANCES:		CUSTOMER PARTS NO.	
-20	-50	-150	150- ANGLE
±0.1	±0.15	±0.2	±0.3 ±1'
3rd Angle Projection		DATE 2016/03/16	SCALE 1:1
		SHEET 4/7	

REV.	DESCRIPTION	DATE