

RevNo	Revision note	Rev-By	RevDate	Signature	Checked

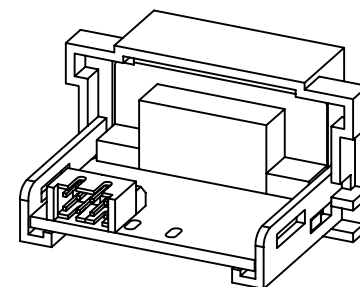

VGA CABLE TYPE MODULE

ITEM NO: FU-HD15-200

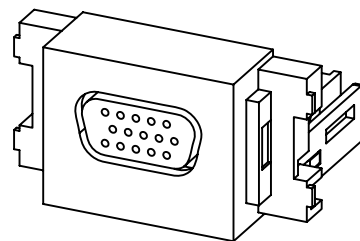
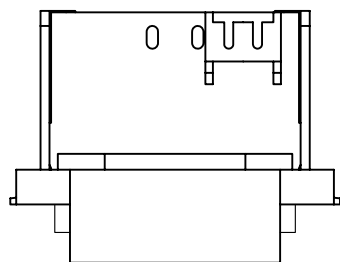

2015-10-30 Update → Before 30.8mm Modify to 31.8mm

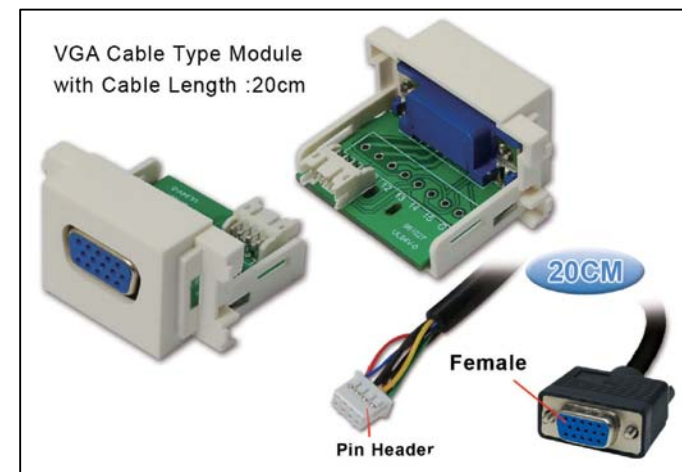
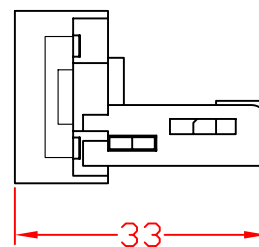
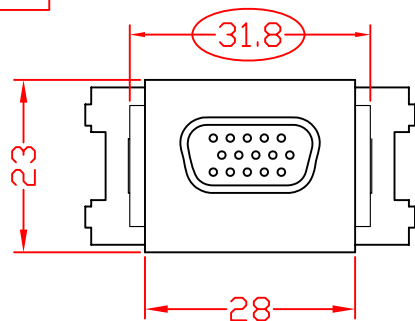

FEATURES:

- VGA Cable Type Module
- with 20cm Pin Head to VGA Cable
- Material : ABS
- Color : RAL9010
- Size: 28 x 23 x 33mm

ITEM NO.	FU-HD15-200			
PART NO.				
DESIGNED BY ALEX	DATE	151030	UNIT	MM
	SCALE	1:1	VER.	1
NO.	Checked by			
APPR:	Approved by -date			

RevNo	Revision note	Rev-By	RevDate	Signature	Checked

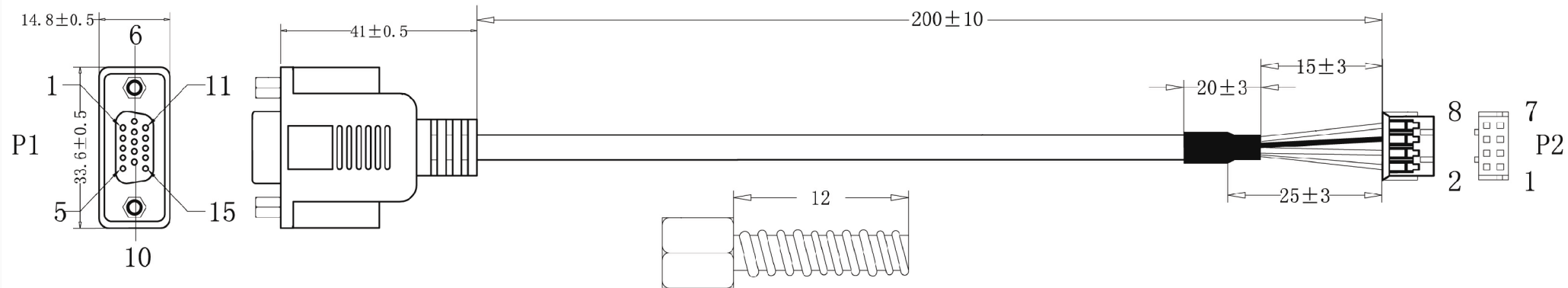

NOTES:

1. 100% OPEN & SHORTS AND MISS WIRE TEST.
 - a. CONTACT RESISTANCE: 5 OHM MAX.
 - b. INSULATION RESISTANCE: 5M OHM MIN.
 - c. HI-POT: DC100V/0.01S.
2. ALL MATERIALS SHALL COMPLY WITH ROHS.

WIRING DIAGRAM		
P1	P2	COLOR
1	5	RED
2	2	GREEN
3	8	BLUE
12	4	ORANGE
13	3	WHITE
14	1	BLACK
15	7	YELLOW
6+7+8+10+G	6	GROUND

ITEM NO.	FU-HD15-200			
PART NO.				
DESIGNED BY SSUMIN	DATE	180213	UNIT	MM
	SCALE	1:1	VER.	1
NO.	Checked by			
APPR:	Approved by -date			