

RevNo	Revision note	Rev-By	RevDate	Signature	Checked

USB-A 2.0 CABLE TYPE MODULE

ITEM NO: FU-USBA-200

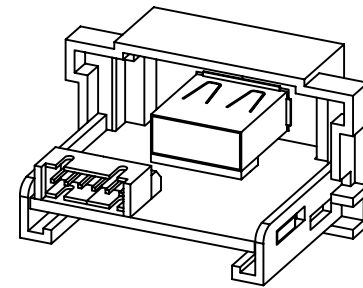
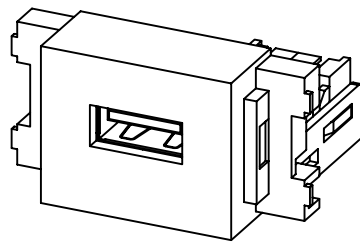
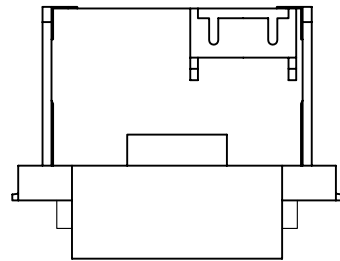

2015-10-30
Update

Before 30,8mm
Modify to 31,8mm

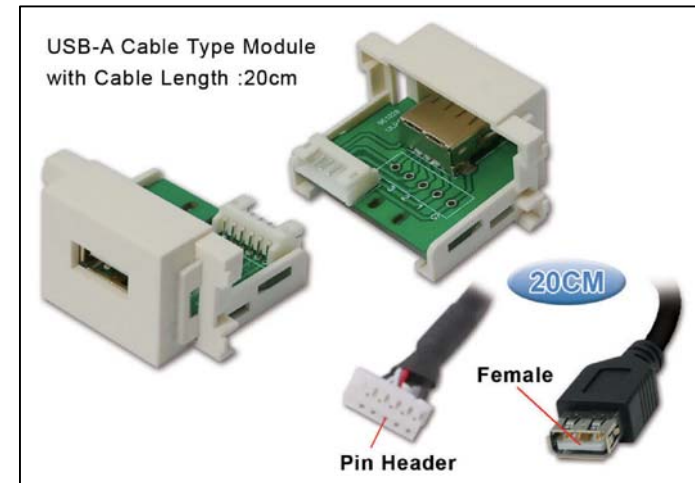
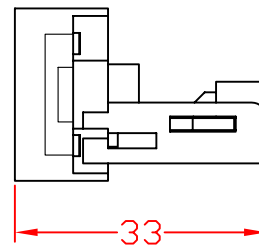
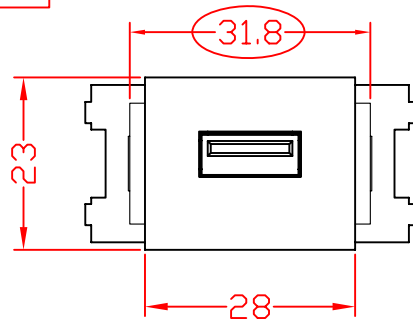

FEATURES:

- USB-A 2.0 Cable Type Module
- with 20cm Pin Head to USB-A Female Cable
- Material : ABS
- Color : RAL9010
- Size: 28 x 23 x 33mm

ITEM NO.	FU-USBA-200			
PART NO.				
DESIGNED BY ALEX	DATE	151030	UNIT	MM
	SCALE	1:1	VER.	1
NO.	Checked by			
APPR:	Approved by -date			

RevNo	Revision note	Rev-By	RevDate	Signature	Checked

USB-A 2.0 CABLE TYPE MODULE

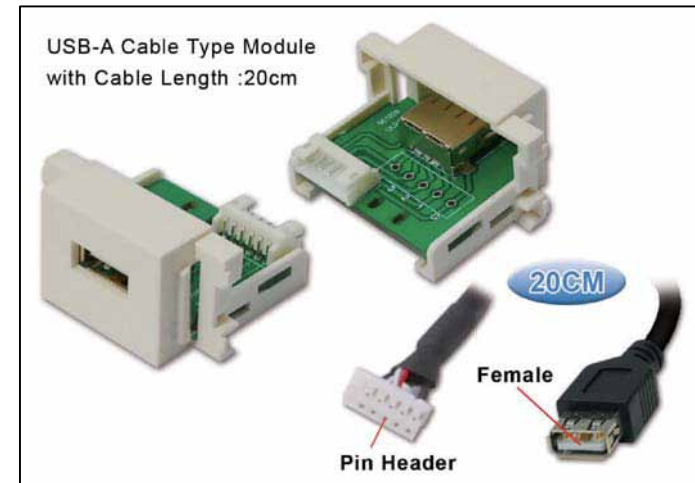
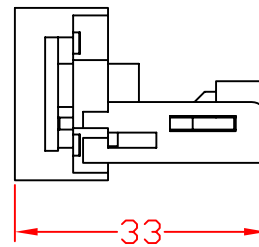
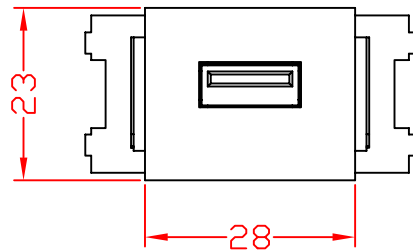
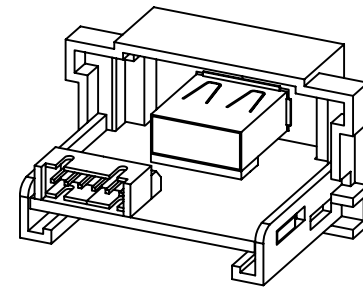
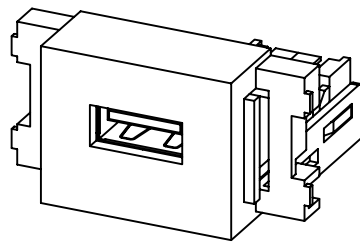
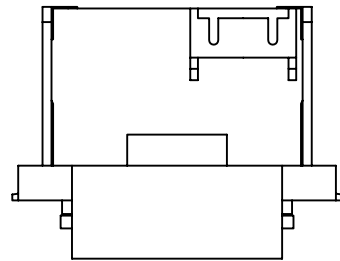

FEATURES:

- USB-A 2.0 Cable Type Module
- with 20cm Pin Head to USB-A Female Cable
- Material : ABS
- Color : RAL9010
- Size: 28 x 23 x 33mm

ITEM NO.	FU-USBA-200			
PART NO.				
DESIGNED BY ALEX	DATE	140222	UNIT	MM
	SCALE	1:1	VER.	1
NO.	Checked by			
APPR:	Approved by -date			

RevNo	Revision note	Rev-By	RevDate	Signature	Checked

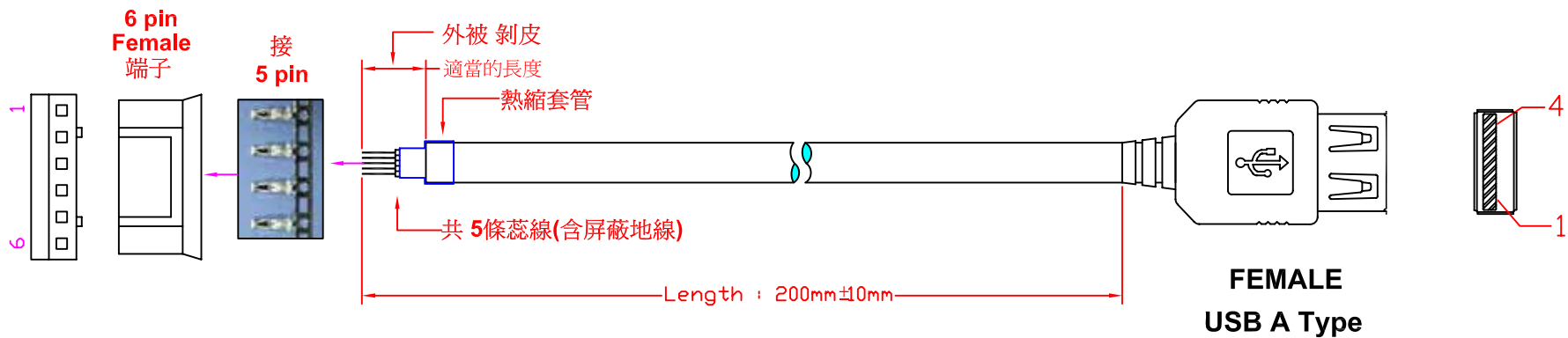

PIN OUT

端子	USB A Type (Female)
6	No connect N/A
2	紅色 1 (V Bus)
3	白色 2 (D-)
4	綠色 3 (D+)
5	黑色 4 (Ground)
1	外殼 G (Shielded)

ITEM NO.	FU-USBA-200			
PART NO.				
DESIGNED BY ALEX	DATE	130514	UNIT	MM
	SCALE	1:1	VER.	1
NO.	Checked by			
APPR:	Approved by -date			