

HEX NUT (X2)

JPBKFP-HD15

ASSEMBLY DRAWING

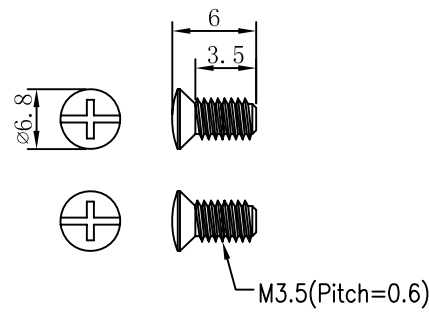
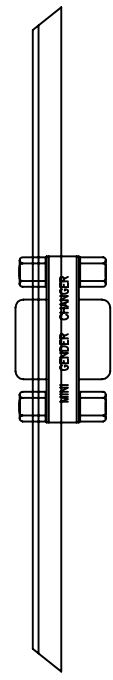

SCREW(2PCS)

NET MECHANISM Corp www.cabling-ol.net				
SCALE	NONE		REV	A
UNIT	MM			
SHEET	2/2	DWG NO.		
DATE	11/23/10			
TITLE HDB15F TO HDB15F Adapter With Metal Face Plate				
PART NO. WPAD-MJ-HD15				

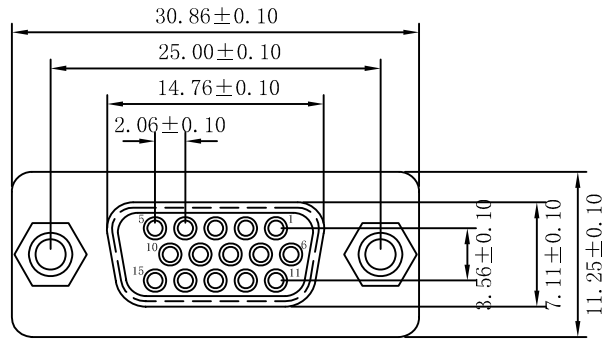
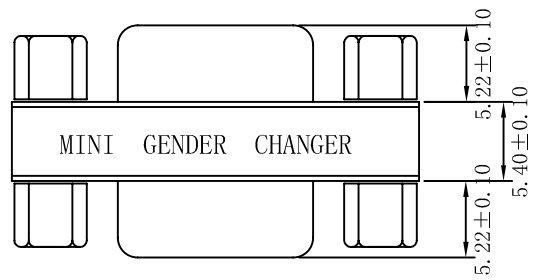
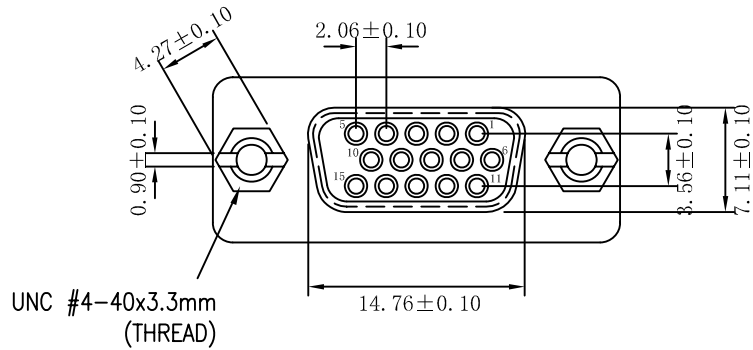

- NOTES:
1. ADAPTER: HD15F TO HD15F ADAPTER. WITH 4PCS #4-40 NUT.
  2. 120 JP METAL FACEPLATE: HD15F, STAINLESS STEEL, THICKNESS: 0.8MM.
  3. SCREW: M3.5 (PITCH: 0.6MM), L=6MM, NICKEL PLATED.

UNC #4-40 Hexscrew      UNC #4-40 Hexnut

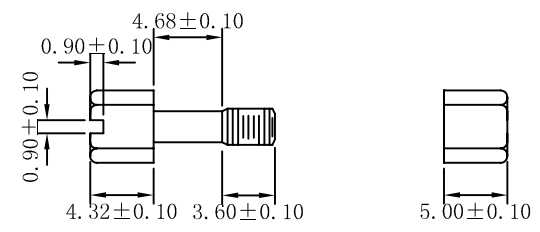

HGCF 15 F/F GENDER CHANGER  
PIN OUT: 15Female      15Female

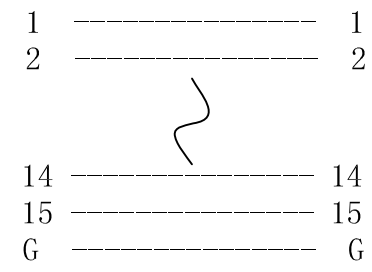

Label: yellow color with black character  
One side: MINI GENDER CHANGER  
The other side: U.S.A. PATENT 5199906 GENDER CHANGER  
SPECIFICATION  
INSULATOR: PBT Glass fibre reinforced UL 94 V0  
CONTACT: Brass  
CONTACT PLATING: Gold plated over nickel  
SHELL: Tin Plated Shell (Nickel Silver)  
CURRENT RATING: 3 AMP  
DIELECTRIC STRENGTH: 1000V AC for one minute  
INSULATOR RESISTANCE: 1000MΩ min at 500V DC  
TEMPERATURE: -55° C — +105° C

NET MECHANISM Corp www.cabling-ol.net				
SCALE	NONE		REV	A
UNIT	MM			
SHEET	1/2	DWG NO.		
DATE	11/23/10			
TITLE HDB15F TO HDB15F Adapter With Metal Face Plate				
PART NO. WPAD-MJ-HD15				