

JPFP-HD15F

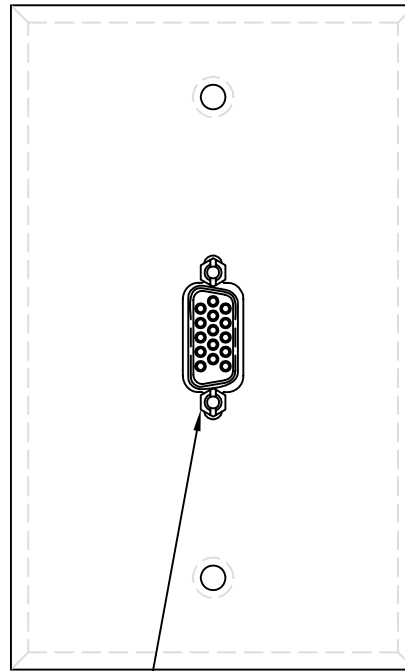

HEX NUT (X2)

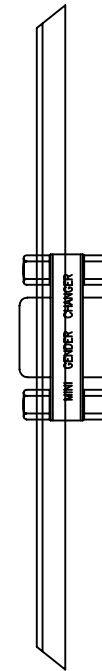

ASSEMBLY DRAWING

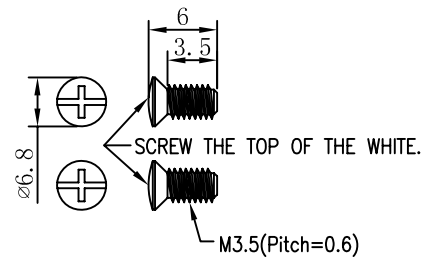

SCREW(2PCS)

NET MECHANISM Corp				
www.cabling-ol.net				
SCALE	NONE		REV	A
UNIT	MM			
SHEET	2/2	DWG NO.		
DATE	11/23/10			
TITLE				
HDB15F TO HDB15F Adapter With Metal Face Plate				
PART NO.				
WPAD-WH-HD15				

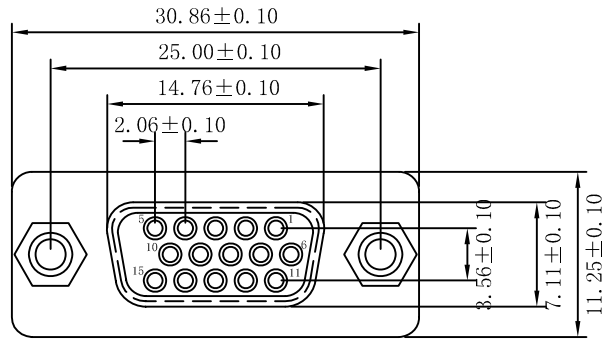
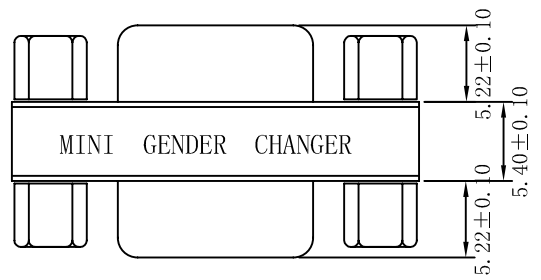
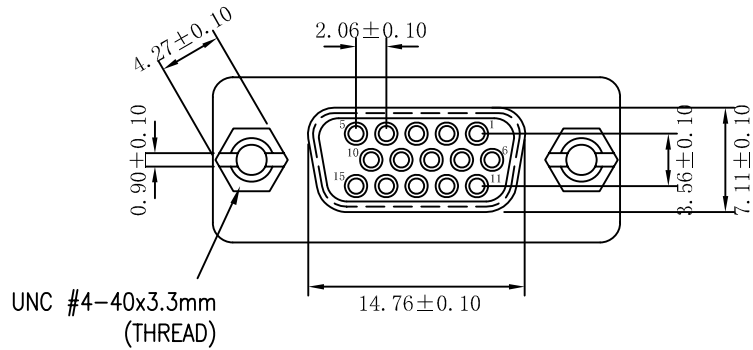

UNC #4-40 Hexscrew

UNC #4-40 Hexnut

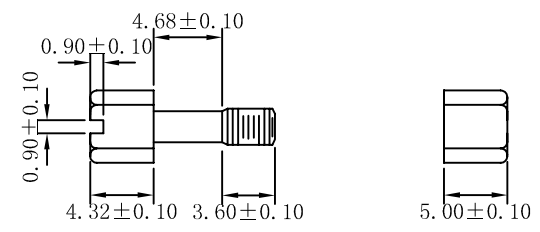

HGCF 15 F/F GENDER CHANGER

PIN OUT: 15Female 15Female

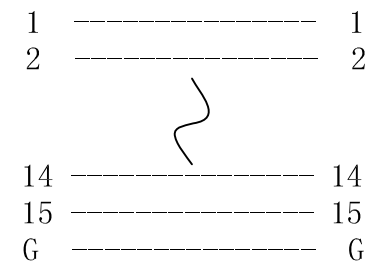

Label: yellow color with black character
One side: MINI GENDER CHANGER
The other side: U.S.A. PATENT 5199906 GENDER CHANGER

SPECIFICATION
INSULATOR: PBT Glass fibre reinforced UL 94 V0
CONTACT: Brass
CONTACT PLATING: Gold plated over nickel
SHELL: Tin Plated Shell (Nickel Silver)
CURRENT RATING: 3 AMP
DIELECTRIC STRENGTH: 1000V AC for one minute
INSULATOR RESISTANCE: 1000MΩ min at 500V DC
TEMPERATURE: -55° C — +105° C

NOTES:

1. ADAPTER: HD15F TO HD15F ADAPTER. WITH 4PCS #4-40 NUT.
2. 120 JP METAL FACEPLATE: HD15F, STAINLESS STEEL, THICKNESS: 0.8MM. COATING: WHITE.
3. SCREW: M3.5 (PITCH: 0.6MM), L=6MM, NICKEL PLATED. SCREW THE TOP OF THE WHITE.

NET MECHANISM Corp www.cabling-ol.net				
SCALE	NONE		REV	A
UNIT	MM			
SHEET	1/2	DWG NO.		
DATE	11/23/10			
TITLE HDB15F TO HDB15F Adapter With Metal Face Plate				
PART NO. WPAD-WH-HD15				